

ST185 Prototype of 16 m² with 1 open side

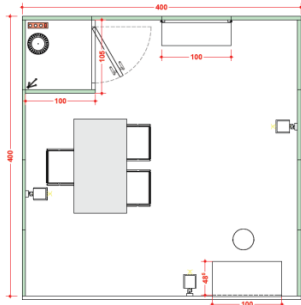

STRUCTURE

Deep red carpet set down with nylon protection sheet
White painted wood panels H 300 cm
White painted upper board H 40 cm
White painted columns cm 20x20
Store room cm 100x100 with lockable leaf door

ELECTRICAL EQUIPMENT

N. 3 Led spotlights 30 W
N. 1 multiple socket 220V inside the store room (absorption up to 1,5 kw)

GRAPHICS

N. 1 sign for each open side
with Exhibiting Company Name in black Arial cut vinyl

FURNITURE

N. 1 white rectangular table cm 135x75
N. 3 white chairs
N. 3 shelves cm 100x30 mounted on aluminum racks
at cm 110, 140 e 170 above the ground - for a different positioning,
please contact BF Servizi by December 15th 2021,
N. 1 white info desk cm 100x48.5x100H - customizable front cm 100x98,5H (extra)
N. 1 stool
N. 1 coat rack
N. 1 waste basket

ST185 Prototype of 16 m² with 2 open sides

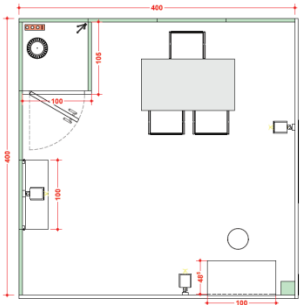

NOTES

The equipment above gets increased by multiples of 16 sqm.
Carpet color may be changed for an extra fee on [BeFair](#).
It is allowed to attach graphics onto the walls only with pins or headless nails.
It is possible to leave out all or some items by notifying it to BF Servizi by
Dicember 15th 2021 - no replacements or price reduction allowed.
Extra furniture can be ordered on [BeFair](#).

IMPORTANT SAFETY NOTES AND REGULATIONS

It is strictly forbidden to add live loads to all pre-fitted booths - Exhibitors who need to attach or hang anything onto the panels must be authorized by BF Servizi.
It is forbidden to use any tool or device that may damage the panels and/or their coating - any damage caused to the booth materials will be priced and charged after the exhibition.
Maximum load allowed on each shelf 5kg. If not arranged in advance, positioning may be changed on-site only by BF Servizi: an extra fee may be applied.